

4 Align Doors
• Align • Screw by hand

Unlock screw in Wheel Bracket and adjust the wheel by hand to raise or lower the door. After adjustment tighten screw again.

Note: wheels should be adjusted to reduce any door movement vertically.



5 Fix Handles • Assemble • Screw

Place 30mm Bolts through Inner Handle. Place Spacers onto Bolts and offer through holes in glass. Align outer handle onto Bolts and tighten with Allen Key (supplied).

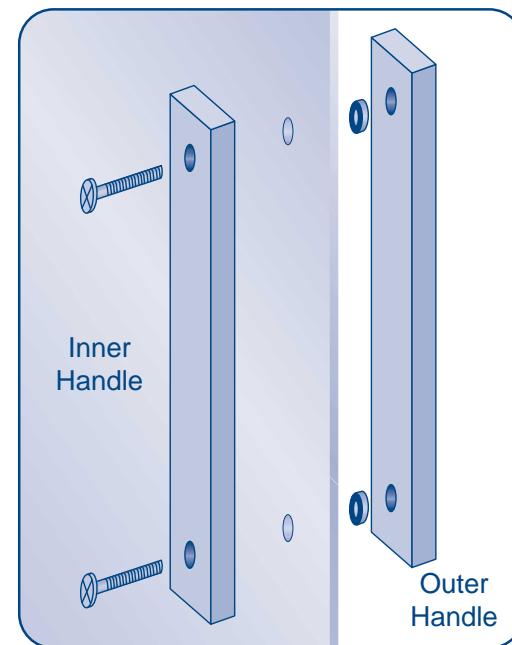
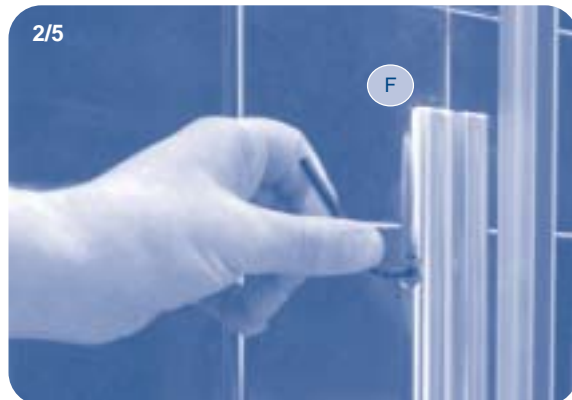

6 Waterproofing
• Silicone Seal

Seal the **OUTSIDE** edge of the shower with suitable bathroom silicone all around the Shower Tray and the joining between the Wall Brackets (A) and the tiled wall. Allow to set for a minimum of 24 hours before using the shower.



BEFORE YOU INSTALL YOUR JUMBO SLIDER SHOWER ENCLOSURE PLEASE READ ALL INSTRUCTIONS. FAILURE TO DO SO MAY LEAD TO INVALIDATION OF YOUR WARRANTY.

- Your enclosure **MUST** always be fixed onto a sturdy tiled wall to ensure a waterproof shower.
- The shower tray **MUST** be fitted level, tiled in and sealed along it's entire wall length.
- The shower should be sealed using silicon sealant, vertically inside and out and horizontally on the outside only. This allows any water trapped inside the frame to escape into the tray.
- **WARNING:** Check walls for electric cabling or water pipes before drilling.

Tools required to install your new Fresca Jumbo Slider Shower Enclosure

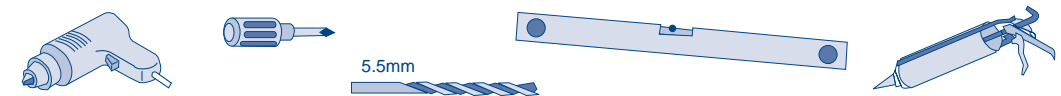

1 Fit Wall Bracket x 2 • Drill • Plug • Screw



1/1 Fit wall brackets (A) 10mm in from the outside of the shower tray ensuring the profile is square. Mark each hole for position.



2/1



3/1 Drill with a 5.5mm masonry drill bit.



4/1 Insert wall plugs into drilled holes.



5/1 Insert a 38mm screw into collar x 3 and secure one wall bracket on the side where the fixed panel will be



6/1 Snap screw head cover on all screws

2 Door Assembly

Slide Wheel Tracks onto fixed panel ensuring drilled holes on both fixed panel and wheel tracks are facing upwards.
Note: use cardboard on floor to prevent damage to product.

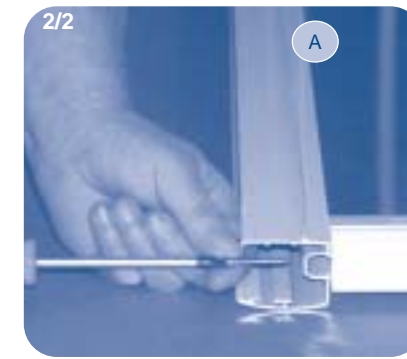

2/2 Secure Panel with 4x35mm screws



3/2 Place 4x10mm screws

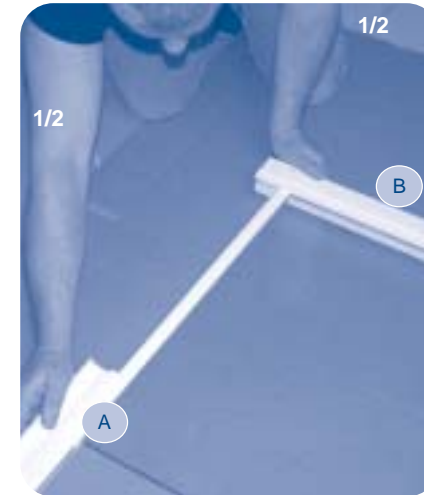

1/2

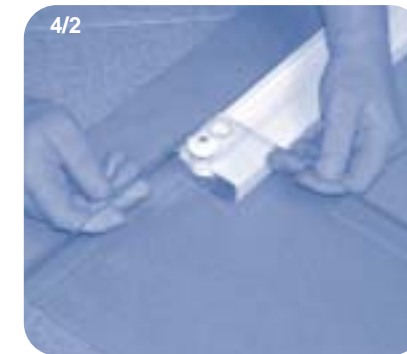

4/2



5/2

Slide door in to place as shown carefully aligning wheels on to track



1/3

3 Secure Door



6/2 Secure Door Jamb with 4x35mm screws

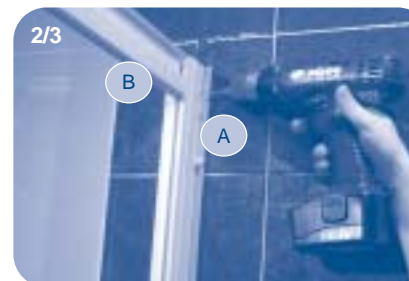

2/3



3/3

Place Wall Bracket on door opening side of the product and carefully lift the product and (A) place in to the secured wall profile (B) rotate the product in to position and secure the Wall Bracket as per step (5/1) above.

Ensure fixed panels are square drill through existing hole in Fixed Panels (B) into fixed Wall Brackets (A) top and bottom.

Insert 12mm screw into collar x 4 and secure. Snap screw head covers on top and bottom.

- | | | |
|--|---|---|
| <ul style="list-style-type: none"> x 6 x 6 (38mm) x 4 (12mm) x 10 x 10 x 1 (ø3mm) <p>F009</p> | <ul style="list-style-type: none"> x 8 (35mm) x 2 (10mm) <p>F019</p> | <ul style="list-style-type: none"> x 2 (30mm) x 2 x 1 <p>F017</p> |
|--|---|---|

- (A) Wall brackets
- (B) Fixed Panel
- (C) Wheel Track
- (D) Door Jamb
- (E) Sliding door
- (F) Handle

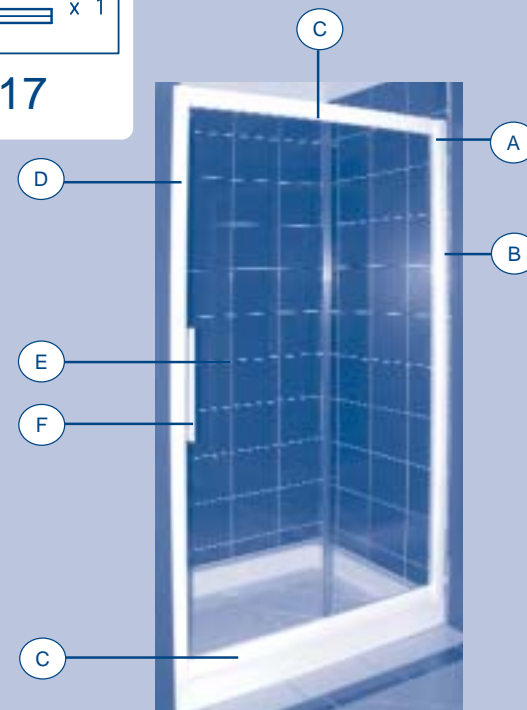

fresca
do it with flair

SIDE PANEL
Shower Enclosure

Instructions



**BEFORE YOU INSTALL YOUR SIDE PANEL
PLEASE READ ALL INSTRUCTIONS. FAILURE TO DO SO MAY
LEAD TO INVALIDATION OF YOUR WARRANTY.**

- Your enclosure **MUST** always be fixed onto a sturdy tiled wall to ensure a waterproof shower.
- The shower tray **MUST** be fitted level, tiled in and sealed along it's entire wall length.
- The shower should be sealed using silicon sealant, vertically inside and out and horizontally on the outside only. This allows any water trapped inside the frame to escape into the tray.
- **WARNING:** Check walls for electric cabling or water pipes before drilling.

Tools required
to install your
new Fresca
Side Panel

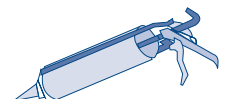
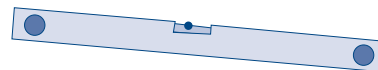
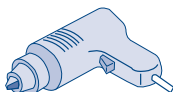

1/INS/0397

1

Refer to the instructions supplied with your shower door for wall bracket fixing

2

Secure Door

- Position
- Seal
- Snap into place



Apply a bead of silicone sealant along the "V" groove on the inner face of the door profile



Carefully slide Side Panel and shower door fully in to fixed wall brackets



Align the side panel and door profiles as shown. Then hinge and snap in to place, apply two 100mm lengths of masking or duct tape to hold the profiles together while the silicone cures.

4

Proceed with installation using the instructions supplied with selected door.